



924 N Pennsylvania St, Ste B | Indianapolis, IN 46204  
(317) 275-1169 | [www.thecabaret.org](http://www.thecabaret.org)

## **2025 TECHNICAL SPECIFICATIONS**

[Cabaret Virtual Tour](#)

### **STAGE**

13'-6" deep X 22'-8" wide. The stage is semi-circular with wood flooring.

### **IN-HOUSE BACKLINE**

#### **PIANO:**

Yamaha C3X 6'1" Grand

#### **KEYBOARD:**

Kawai ES6 Digital Piano

#### **BASS AMP:**

Gallien Krueger 400RB Mark IV

#### **GUITAR AMP:**

Fender Hot Rod Deville 212

#### **DRUMS:**

Yamaha Maple Custom Absolute Drum Kit

- 20 x 18 Kick Drum, ABD 1020T
- 14 x 5.5 Snare Drum, ASD0105, SN QM2158
- 14 x 14 Floor Tom with Legs, AFT 1514
- 12 x 8 Rack Tom with YESS Mount, QNP1984 AFT 1512
- 10 x 8 Rack Tom, ATT 1010, SN QP0066
- SS850 Snare Stand
- HS850 High Hat Stand
- 14" Zildjian High Hats, 20" Zildjian Ride, 18" Zildjian Med. Crash, 16 Zildjian Thin Crash
- Yamaha Kick Drum Pedal
- Four (4) DW9700 Boom/Straight Cymbal Stands
- Yamaha 3-Hole Receiver with 2 each TH945B Tom Mounts
- Pearl Roadster Padded Throne

Acrylic Drum Shield System with ClearSonic LidPac

### **BACKLINE AVAILABLE FOR RENT**

#### **DOUBLE BASS:**

3/4 fully carved acoustic bass set up for jazz with adjustable bridge

- D'Addario pizzicato med gage bass strings
- Fishman Full Circle bass pickup (already set up on bridge)
- French style bass bow (wooden)

#### **ELECTRIC BASS:**

Fender 5-string Jazz Bass

### **AUDIO**

Lighting/Sound booth is centrally located at rear of house. Professional technician provided.

#### **dBc LIMITS:**

The Cabaret is a small, live room. Sound meter levels are monitored with a properly calibrated sound level meter at the house mix position. Please note the following sound meter level limits:

- Average continuous power shall not exceed 82 dBc as a live read out.
- Loud passages (<30 seconds) shall not exceed 91 dBc as a live read out.

#### **CONSOLE:**

Allen & Heath SQ7

#### **STAGE BOX:**

Allen & Heath GX4816

#### **SYSTEM PROCESSING:**

DBX Drive Rack PA2

#### **AMPLIFIERS:**

2 x Crown XTi 6002

Channels: 2 @ 2100W ea (4 ohm)

#### **HOUSE SPEAKERS:**

Mains:

- 2 x JBL CBT1000 + CBT1000E
- Frequency response 38 Hz – 20 kHz (to -10 dB)
- Power handling 3,000W
- Max SPL 127 dB continuous

- Subs:  
- 2 x Klipsch KP-682, Passive  
Outfills:  
- 2 x JBL

**STAGE MONITORS:**

4 x Turbosound TFX122MAN 1100W 12" 2-way Active  
6 x Electro Voice ZxA1-90  
Frequency response 60 Hz – 20 kHz

**MICROPHONES:**

- Wireless:  
- 4 x Shure Beta 58  
- 2 x Shure Beta 87A  
- 2 x Shure WL185 Lavalier  
- 1 x Countryman Headset  
Receiver:  
- Shure ULXD4Q  
Wired:  
- 2 x Shure Beta 58  
- 2 x Shure SM 58  
- 2 x Neumann KMS 105  
Piano:  
- 2 x DPA 4099  
Instrument, dynamic:  
- 3 x Shure SM 57  
Instrument, condenser:  
- 2 x Shure SM 81  
- 2 x Shure Beta 98 a/c  
- 2 x Audio-Technica ATM 450  
- 1 x Shure VP88 Stereo (House Room Mic)

**DIRECT BOXES:**

2 x Radial JDI Passive  
2 x Radial J48 Active

## LIGHTING

**CONTROL:**

ETC CS40 Color Source 40

**FIXTURES:**

- Front Light:  
- 10 x Elation DTW PAR300  
• "Dim-to-warm" LED with barndoors  
• General stage wash with DSC special area  
Back Light:  
- 10 x Elation SixPar300  
• RGBWA+UV LED with barndoors  
• General stage wash  
Special:  
- 6 x Elation WW Profile HP, 2 x 19 deg  
Other:  
- 5 x Elation SixBar1000  
• Grazing downlight for upstage wall  
- 2 x Elation Arena PAR Zoom  
• RGBW LED grazing light for drapery

## VIDEO

**PROJECTORS:**

2 x Epson Cinema Pro 4040

**SCREENS:**

2 x drop-down remote motor-controlled screens on each side of stage

**SWITCHER:**

1 x Blackmagic Design ATEM Mini Pro

**COMPUTER:**

1 x Mac Mini for media playback and PowerPoint slides via HDMI

## MISCELLANEOUS

<u>MUSIC STANDS:</u>	6 x
<u>STAND LIGHTS:</u>	4 x cordless stand lights, LED
<u>MIC STANDS:</u>	6 x Straight, round base 3 x Tall Tripod booms 3 x Short Tripod booms
<u>GUITAR STANDS:</u>	4 x
<u>STOOLS:</u>	2 x 36" 2 x 30" 2 x 24"
<u>SMALL TABLES:</u>	1 x 36"

## CABARET CONTACTS

<u>CONTRACTS:</u>	Shannon Forsell	Office (317) 653-1305   Cell (317) 371-8536   <a href="mailto:shannon@thecabaret.org">shannon@thecabaret.org</a>
<u>ADVANCING:</u>	Brian Oakley	Office (317) 419-2448   Cell (317) 691-5368   <a href="mailto:brian@thecabaret.org">brian@thecabaret.org</a>
<u>PROMOTION/MEDIA:</u>	Britnee King	Office (317) 653-1304   Cell (317) 750-3172   <a href="mailto:britnee@thecabaret.org">britnee@thecabaret.org</a>
<u>TICKETING/BOX OFFICE:</u>	Tim Alan Thompson	Office (317) 653-1301   Cell (317) 681-2434   <a href="mailto:tim@thecabaret.org">tim@thecabaret.org</a>
<u>TECHNICAL DIRECTOR:</u>	Malcolm Johnson	Cell (317) 416-7241   <a href="mailto:tech@thecabaret.org">tech@thecabaret.org</a>

THE  
**CABARET.**  
Shannon Forsell Stage

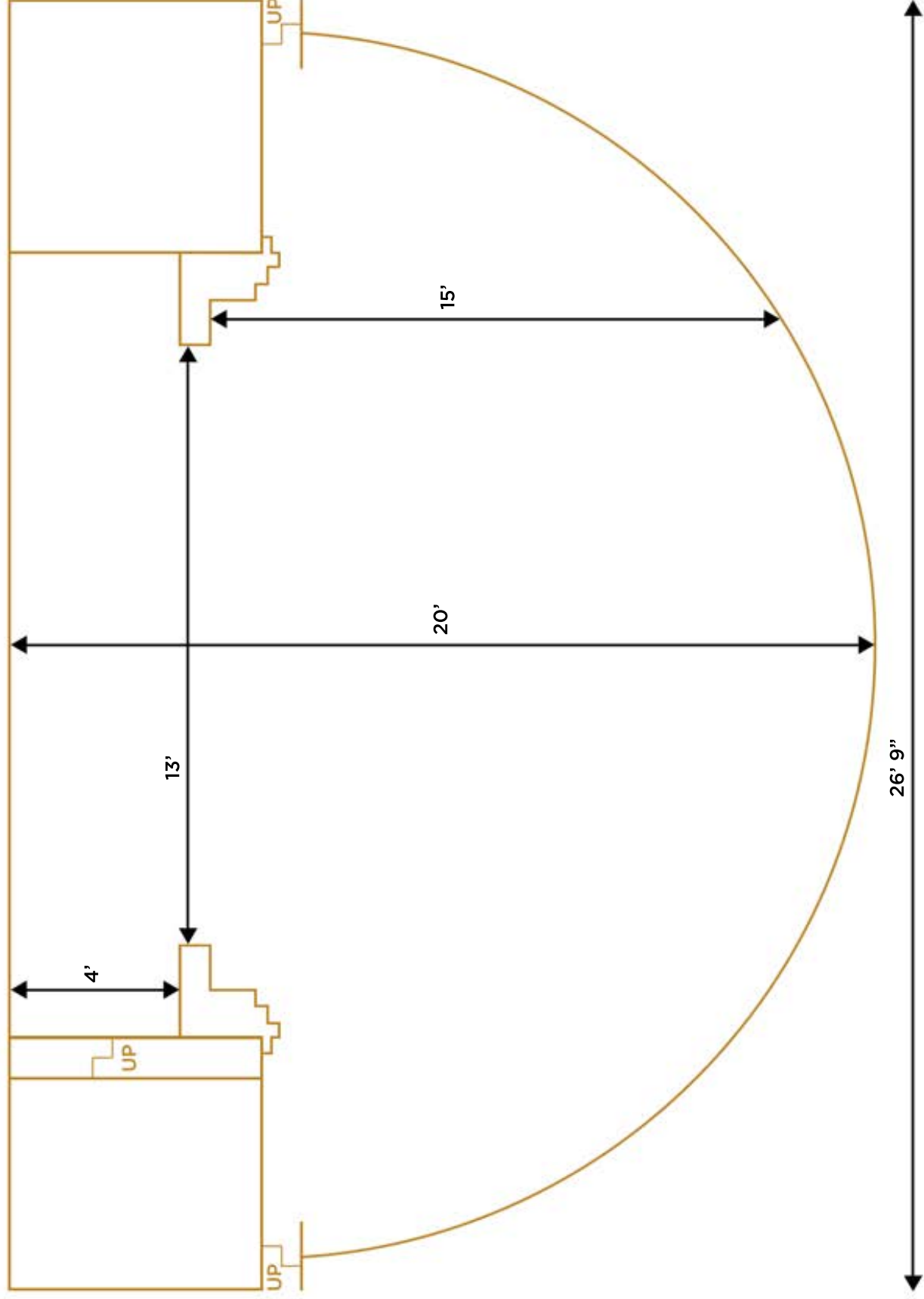

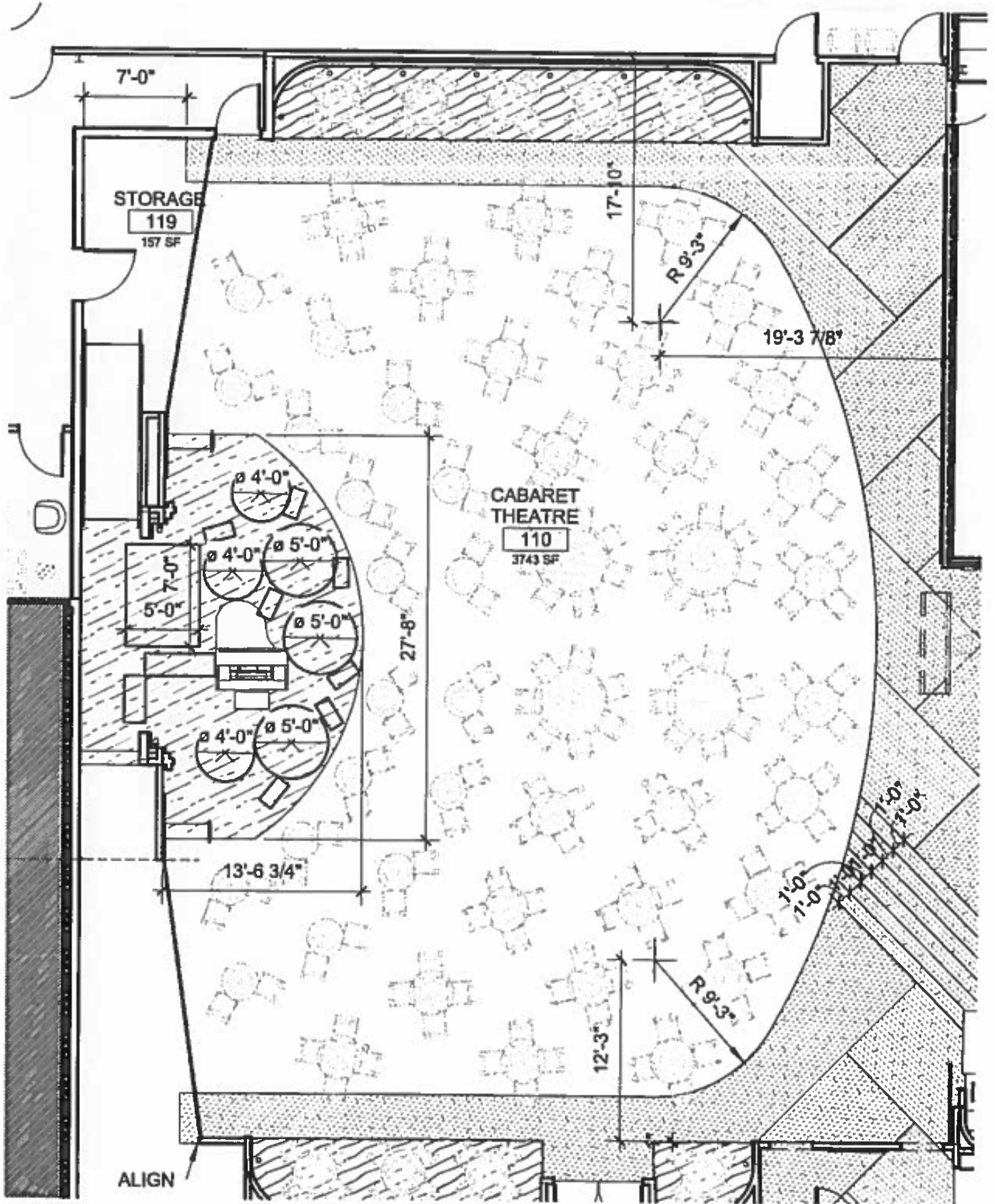

# THE CABARET™ Parking Map

